

CONCEPT PLAN

808108 24th Sideroad

Part of Lot 24, Concession 10
Town of the Blue Mountains
County of Grey



INSET MAP

Scale 1 : 2,000

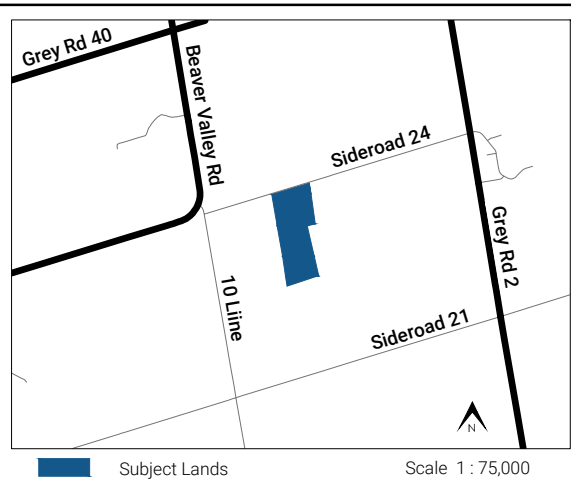

LEGEND

- Subject Lands
Lot Area: ±31.299ha (77.34ac)
Lot Frontage: ±389.5m
- Proposed Multi-purpose Building:
Total Area: ±0.266ha (0.66ac)
- Existing Winery:
Total Area: ±0.136ha (0.34ac)
- Existing Agricultural Related Uses:
Total Area: ±0.159ha (0.39ac)
- Existing Agricultural Use:
Total Area: ±30.738ha (75.95ac)

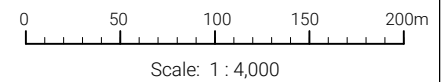

Note: This drawing is for discussion purposes only.
Boundary to be verified by an O.L.S.

Source: Design Option 3, Justin Sherry Design Studio,
August 2, 2024. County of Grey interactive map.

Drawn By: A.M.

Date: February 13, 2025

File No: 1380

MORGAN
PLANNING & DEVELOPMENT

98 Tecumseth Street,
Orillia, ON, L3V 1Y2

Phone: (705) 327-1873
jmorgan@morganplanning.ca